

16374 Pump



- Tools which are needed :
1. Screwdriver (crosshead)
 2. Stanley knife
 3. Combination pliers
 4. Wire-stripper
 5. Connector pliers
 6. Hot-air gun



B. Take tissue well and tissue holder out to get to the location of the pump.

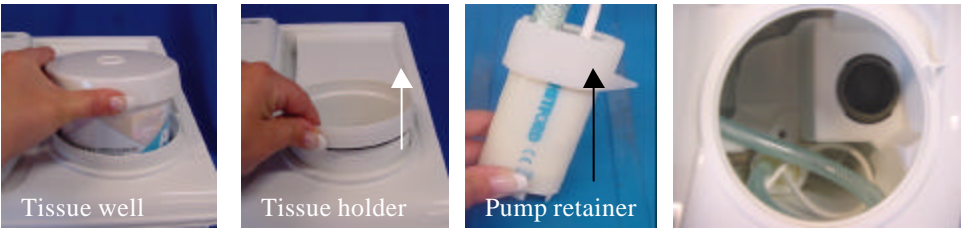

C. Unscrew the screw on the pump retainer and take complete pump out of the water tank.

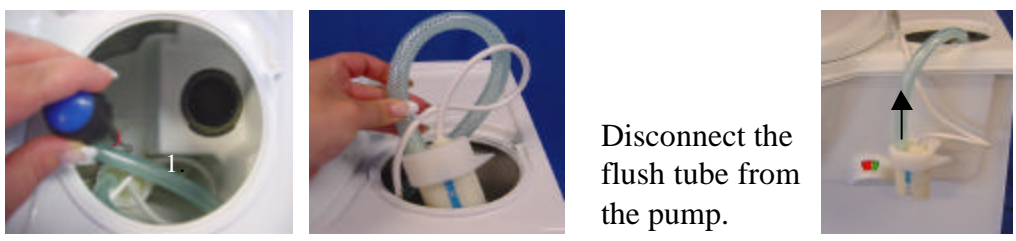

- D. 1. Pump
2. Pump retainer
3. Shrinktube



Note : Cassette toilets produced between 1987 and 1989 have two black connectors on the white cable. If this is the case, the white cable has to be cut above the black connector. Both connectors have to be taken off.

E. Cut the cable just above the pump with the combination pliers.

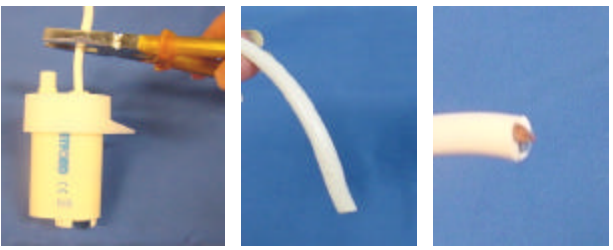

F. Cut the white wire insulation off so that the blue and brown wire stay intact and strip the blue and brown wire with the wire-stripper.

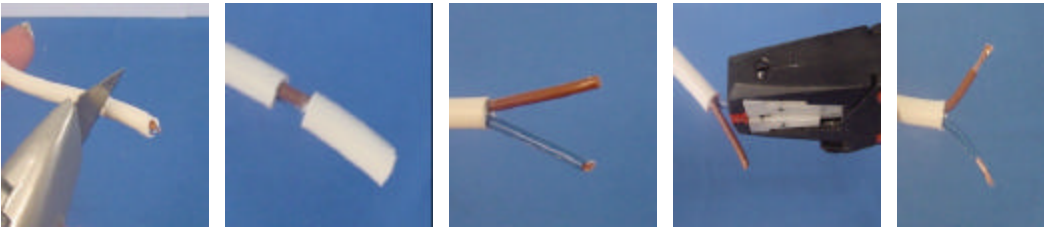

G. Place the pump retainer and shrinktube on the new pump before

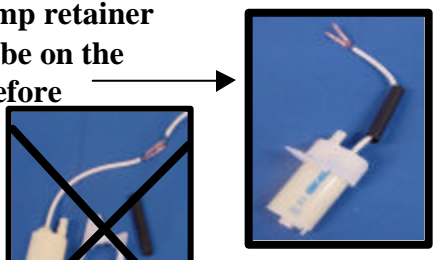

connecting the wires to each other (blue-blue/brown-brown) with the connector pliers.



H. melt the shrinktube with the hot-air gun.
*Melting the shrinktube will prevent that the connected wires will come in contact with the water in the water tank.

Note : When melting the shrinktube make movements from left to right so that the shrinktube can melt gradually.



CAUTION : Make sure that the shrinktube is melted completely to the white wire insulation as otherwise a short circuit can occur.

Also keep in mind that the shrinktube should not be touched after melting, because of burning.

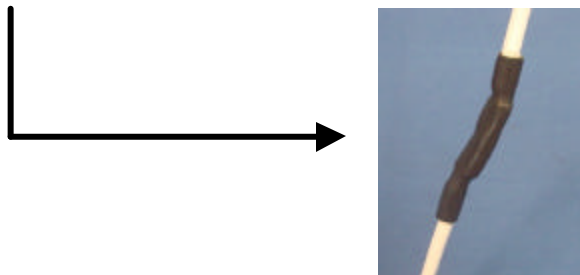

I. Connect flush tube back onto the pump and screw the pump back into the water tank.



J. Place tissue holder and tissue well back into the water tank.

